



ARCHITECTURE PLANNING INTERIOR DESIGN
 15810 PARK TEN PLACE, SUITE 300
 HOUSTON, TEXAS 77084
 713-465-4650
 www.sligroup.com

© COPYRIGHT



NECHES LUMBERTON OFFICE ADDITION
 299 Country Lane at U.S. 69
 Lumberton, Texas 77657

E/B/E PROJECT NUMBER: 26028.00

LUMINAIRE SCHEDULE									
SYMBOL	QTY	LABEL	MOUNTING HEIGHT	ARRANGEMENT	DESCRIPTION	LLF	LUMINAIRE LUMENS	LUMINAIRE WATTS	TOTAL WATTS
⊗	6	A @ 27W 3500°K	9	SINGLE	WILLIAMS P/N: FT-24-LS-8CS-AF-DIM-UNV 27W@3500K	0.900	4111	27.309	163.854
⊗	8	A @ 39W 3500°K	9	SINGLE	WILLIAMS P/N: FT-24-LS-8CS-AF-DIM-UNV 39W@3500K	0.900	5765	38.9	311.2

CALCULATION SUMMARY							
LABEL	CALCTYPE	UNITS	AVG	MAX	MIN	AVG/MIN	MAX/MIN
BREAK ROOM 103_FLOOR	ILLUMINANCE	Fc	31	39	23	1	2
HALL 100_FLOOR	ILLUMINANCE	Fc	24	30	12	2	3
OFFICE 101_WORKPLANE	ILLUMINANCE	Fc	48	66	31	2	2
OFFICE 102_WORKPLANE	ILLUMINANCE	Fc	48	66	31	2	2
OFFICE 104_WORKPLANE	ILLUMINANCE	Fc	48	66	31	2	2
OFFICE 105_WORKPLANE	ILLUMINANCE	Fc	48	66	31	2	2

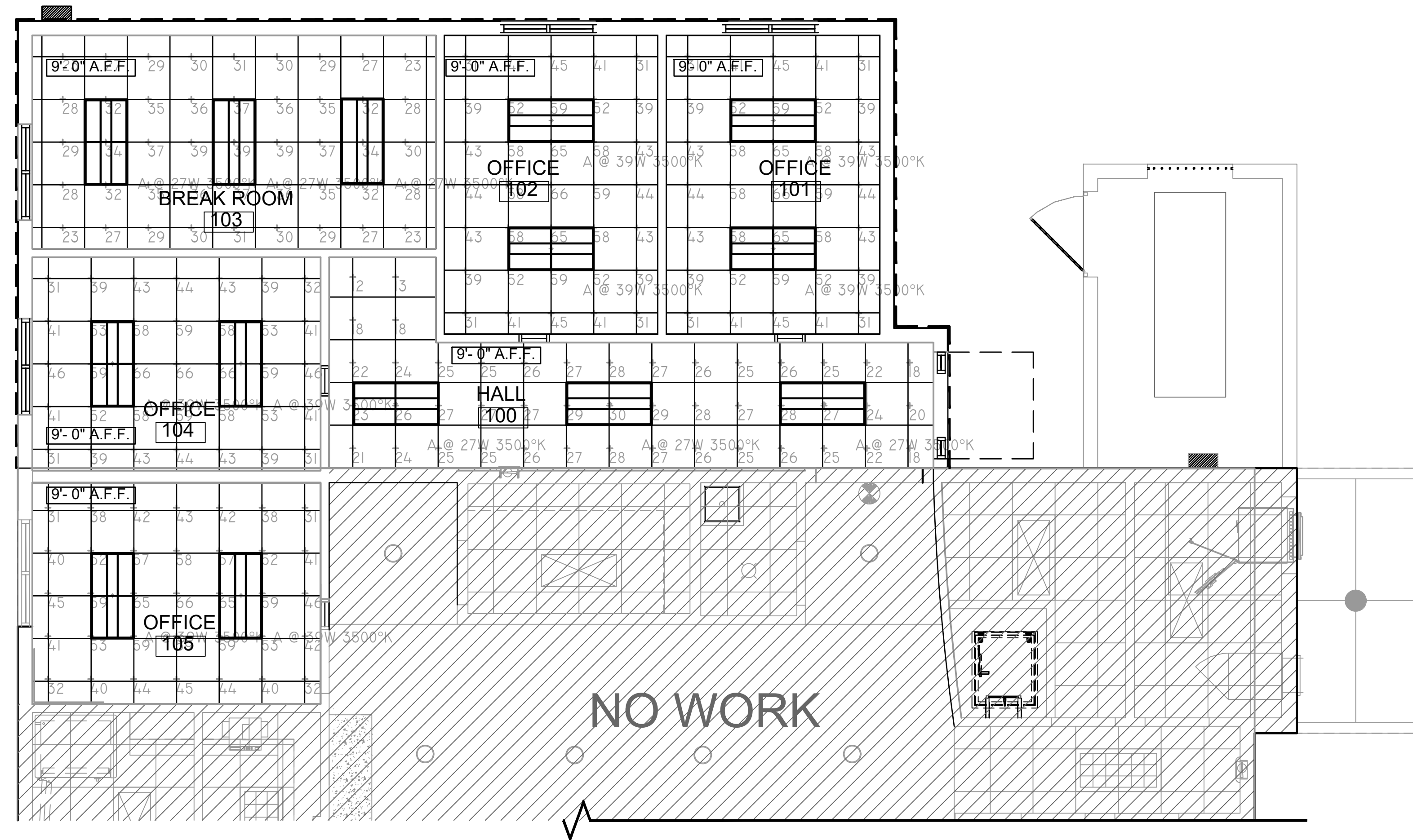

⊗ 01 REFLECTED CEILING PLAN
 SCALE: 1/4" = 1'-0"

ISSUED FOR CLIENT APPROVAL	DATE
ISSUED FOR BIDDING	04/30/2026
ISSUED FOR PERMIT	04/30/2026
ISSUED FOR CONSTRUCTION	

REVISIONS

MARK	DESCRIPTION	DATE
	REVIEW SET	03-27-2026
	90% REVIEW SET	04-13-2026
	BID AND PERMIT	04-30-2026

The information, ideas, designs, details, layouts, techniques, features, arrangements, plans, sequences, dimensions, allowances, tolerances, conceptions, specifications, intentions, technology or embodiments, as illustrated, arranged, displayed, noted, recorded, indicated, represented, disclosed, evidenced, detailed or otherwise reduced to tangible form hereon, either expressly, inherently or by implication, are the confidential and proprietary information of SLI Design, Inc. and shall not be used for any purpose other than the specific project or undertaking identified on the drawing title block or legend for which they are and have been prepared by SLI Design, Inc. Any other reproduction, disclosure or use of any portion of the confidential and proprietary information of SLI Design, Inc., shall be a breach of the obligation of confidence created by the acceptance of this drawing from SLI Design, Inc. for a specific project and Contract. Any copying, duplicating, reproducing, utilization, alteration, modification, revision or change to this drawing, is expressly prohibited unless done with the prior written consent or approval of SLI Design, Inc. and shall not be undertaken without receipt of such prior written approval. This drawing is loaned by SLI Design, Inc., for the limited purpose of complying with a specific Contract. The drawing remains the property of SLI Design, Inc. and shall be returned upon request or completion of the contract, unless specifically authorized by Contract, under which it was loaned.

DESIGN TEAM
 PM: JG
 MECHANICAL: CC
 ELECTRICAL: JG
 PLUMBING: JG
 CHECKED-BY: JG



DRAWING TITLE
 PHOTOMETRICS - INTERIOR

SHEET NO.

MEP-4.01

EIBIE Mechanical Electrical Plumbing CONSULTING ENGINEERS
 12603 Southwest Frwy, Ste 170, Stafford, Tx 77477
 Tel: (713) 840-0177 / Firm Reg. No: 5638