

Date: Thu, 30 Apr 2026 8:33am
 User Name: kender
 Path Name: C:\Users\kender\OneDrive - proeconsulting.com\Projects\1018 - SU Group\0015 - Neches FCD Lumberton V2 CAD\Private Phase 3\07 GRADING & PAVING PLAN.dwg

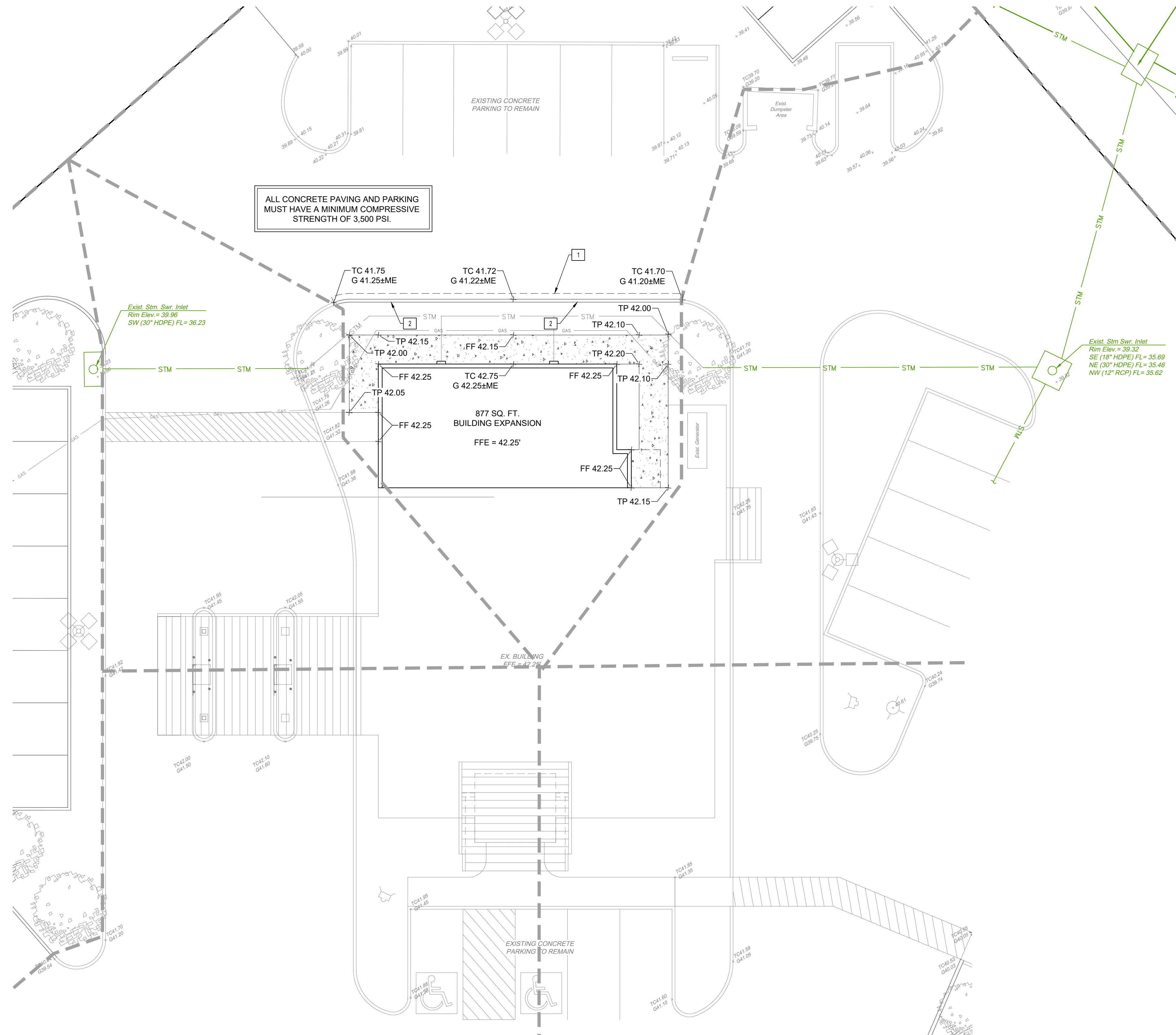

ALL CONCRETE PAVING AND PARKING MUST HAVE A MINIMUM COMPRESSIVE STRENGTH OF 3,500 PSI.

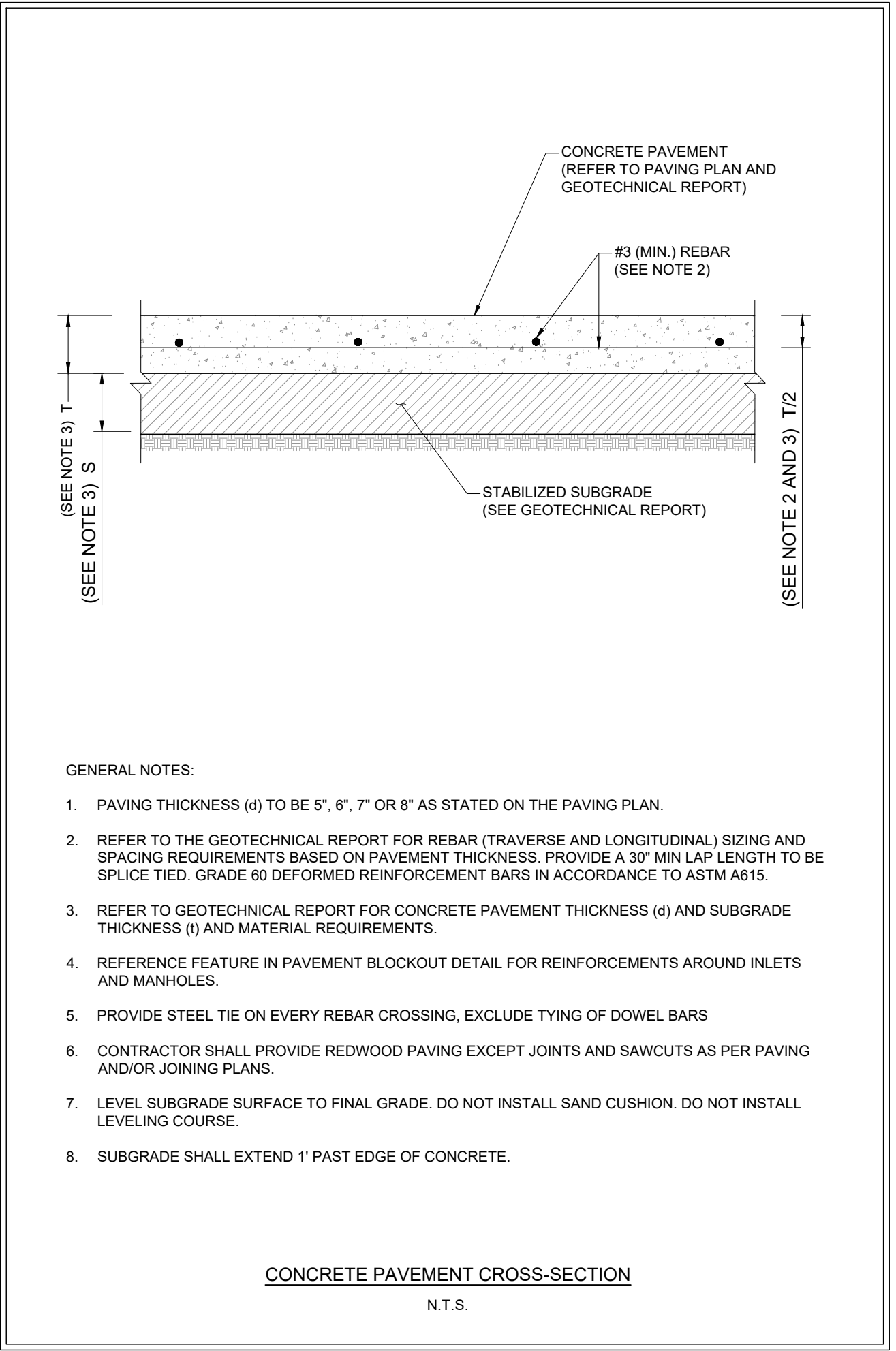

- GENERAL NOTES:
- PAVING THICKNESS (d) TO BE 5", 6", 7" OR 8" AS STATED ON THE PAVING PLAN.
 - REFER TO THE GEOTECHNICAL REPORT FOR REBAR (TRAVERSE AND LONGITUDINAL) SIZING AND SPACING REQUIREMENTS BASED ON PAVEMENT THICKNESS. PROVIDE A 30" MIN LAP LENGTH TO BE SPLICE TIED. GRADE 60 DEFORMED REINFORCEMENT BARS IN ACCORDANCE TO ASTM A615.
 - REFER TO GEOTECHNICAL REPORT FOR CONCRETE PAVEMENT THICKNESS (d) AND SUBGRADE THICKNESS (t) AND MATERIAL REQUIREMENTS.
 - REFERENCE FEATURE IN PAVEMENT BLOCKOUT DETAIL FOR REINFORCEMENTS AROUND INLETS AND MANHOLES.
 - PROVIDE STEEL TIE ON EVERY REBAR CROSSING. EXCLUDE TYING OF DOWEL BARS
 - CONTRACTOR SHALL PROVIDE REDWOOD PAVING EXCEPT JOINTS AND SAWCUTS AS PER PAVING AND/OR JOINING PLANS.
 - LEVEL SUBGRADE SURFACE TO FINAL GRADE. DO NOT INSTALL SAND CUSHION. DO NOT INSTALL LEVELING COURSE.
 - SUBGRADE SHALL EXTEND 1' PAST EDGE OF CONCRETE.

- STORM SEWER AND GRADING CONSTRUCTION NOTES
- ALL PROPOSED STORM SEWERS 12 INCHES AND LARGER SHALL BE CORRUGATED HIGH DENSITY POLYETHYLENE PIPE (HDPE) WITH SMOOTH INTERIOR WITH GASKET JOINTS FOR SITE DRAINAGE.
 - ALL STORM SEWERS TO RECEIVE BEDDING AND BACKFILL IN ACCORDANCE WITH THE DETAILS CONTAINED ON SHEET C6.
 - CONTRACTOR TO ALLOW A MINIMUM OF 1-FOOT VERTICAL CLEARANCE BETWEEN STORM SEWER AND OTHER EXISTING OR PROPOSED UTILITIES.
 - UTILITIES SHOWN ARE APPROXIMATE. CONTRACTOR TO FIELD VERIFY EXISTING UTILITY LOCATIONS PRIOR TO CONSTRUCTION AND IMMEDIATELY NOTIFY ENGINEER OF ANY CONFLICT OR DISCREPANCIES.
 - CONTRACTOR SHALL TAKE CARE NOT TO DAMAGE ANY EXISTING ITEMS ON SITE. ANY DAMAGE SHALL BE REPAIRED OR REPLACED AT CONTRACTOR'S EXPENSE.
 - CONTRACTOR SHALL ENSURE THERE IS POSITIVE DRAINAGE FROM THE PROPOSED PAVEMENT IMPROVEMENTS, AND SHALL NOTIFY ENGINEER IF ANY GRADING DISCREPANCIES ARE FOUND IN THE EXISTING AND PROPOSED GRADES PRIOR TO PLACEMENT OF PAVEMENT AND UTILITIES.
 - ALL SIDEWALKS AND ACCESSIBLE ROUTES, INCLUDING DRIVEWAY CROSSWALKS, SHALL CONFORM TO ALL APPLICABLE AMERICANS WITH DISABILITIES ACT STANDARDS AND THE TEXAS ACCESSIBILITY STANDARDS. IF ANY DISCREPANCY IS DISCOVERED, THE CONTRACTOR SHALL NOTIFY THE ENGINEER PRIOR TO POURING ANY PAVEMENT.
 - ALL STORM SEWER CONNECTIONS SHALL BE WATERTIGHT. CONTRACTOR TO PROVIDE MANUFACTURER-APPROVED COUPLINGS OR ADAPTERS FOR CONNECTION TO EXISTING HDPE PIPE.

- KEYED NOTES
- CONTRACTOR TO SAWCUT AND BREAK BACK EXISTING PAVEMENT. EXPOSE REBAR A MINIMUM OF 12" AS REQUIRED FOR INSTALLATION OF 30" PIPE. RESTORE PAVEMENT AND TIE REBAR AS REQUIRED TO CONNECT PROPOSED PAVEMENT TO EXISTING PAVEMENT. RESTORED PAVEMENT TO MATCH EXISTING THICKNESS AND REINFORCEMENT.
 - PROPOSED 6" CURB.
 - PROPOSED 5' WIDE SIDEWALK.

TOPOGRAPHIC LEGEND

	POWER POLE
	GUY ANCHOR
	SANITARY SEWER MANHOLE
	CLEANOUT
	WATER VALVE
	WATER METER
	ROAD SIGN
	LIGHT POLE
	FIRE HYDRANT
	YIELD SIGN
	STORM SEWER MANHOLE
	AT&T TELEPHONE PEDESTAL
	TELEPHONE PEDESTAL
	TREE

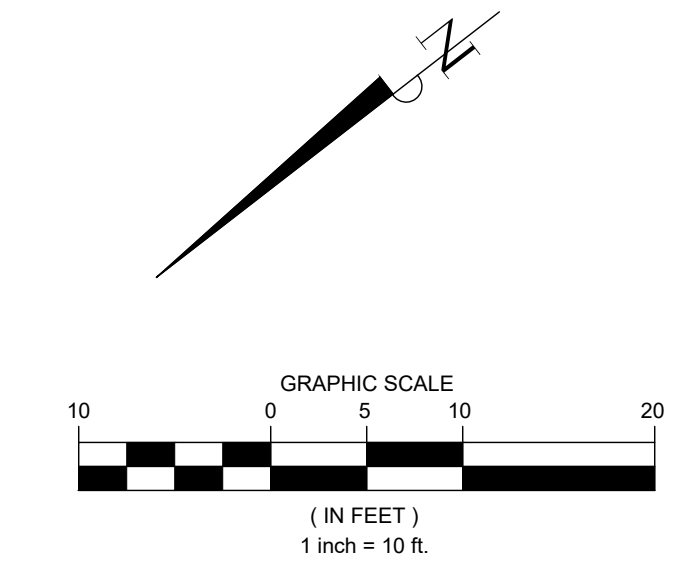

TEMPORARY BENCHMARK "A": ELEV: 38.51'
 BEING A RAILROAD SPIKE EMBEDDED IN A POWER POLE. IT IS LOCATED ±110' FROM THE NORTHWESTERN CORNER OF THE PROPERTY. IT IS ALSO LOCATED ±90' FROM THE NORTHEASTERN CORNER OF THE PROPERTY.

TEMPORARY BENCHMARK "B": ELEV: 39.74'
 BEING THE SOUTHWESTERN CORNER OF A STORM SEWER MANHOLE. IT IS LOCATED ±60' FROM THE SOUTHWESTERN CORNER OF THE PROPERTY. IT IS ALSO LOCATED ±135' FROM THE SOUTHEASTERN CORNER OF THE PROPERTY.

FLOOD STATEMENT:
 THIS PROPERTY LIES WITHIN ZONE "X-UNSHADED" AREAS DETERMINED TO BE OUTSIDE 500-YEAR FLOODPLAIN PER THE FLOOD INSURANCE RATE MAP, COMMUNITY PANEL NO. 48199C0530F WHICH BEARS AN EFFECTIVE DATE OCTOBER 6, 2010.

PRO CONSULTING
 1334 Britton Road
 Suite # 2808
 Houston, TX 77043
 Firm License F-21665
 www.proconsulting.com

STATE OF TEXAS
 JUSTIN A. SCHRAEDER
 LICENSED PROFESSIONAL ENGINEER
 103758
 APR 30 2026
Justin A. Schraeder

DATE	REVISION
04/30/2026	ISSUE FOR PERMIT AND BID

CONSTRUCTION PLANS FOR
**NECHES FEDERAL CREDIT UNION
 - LUMBERTON BRANCH
 BUILDING ADDITION**
 (PRIVATE ON-SITE)
 PAVING & DRAINAGE FACILITIES

299 COUNTRY LANE DRIVE,
 LUMBERTON, TEXAS 77657

GRADING & PAVING PLAN

PRO-E PROJECT NO.: 1018-0015

SUBMITTED:	DESIGNED BY: JAS
SCALE: 1" = 10'	DRAWN BY: KHL/PB
DATE: APRIL, 2026	SHEET NO. C7 OF C10
SURVEYED BY:	CITY DWG NO.:

PRIVATE PLANS - NECHES FEDERAL CREDIT UNION - LUMBERTON BRANCH - BUILDING ADDITION; PROJECT NUMBER : 1018-0015